

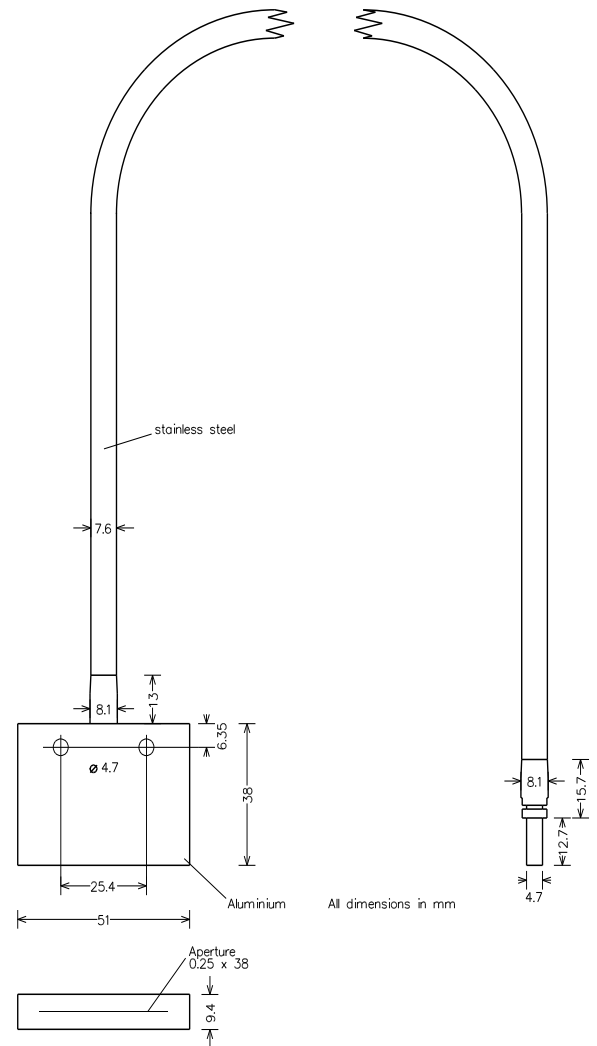

Datasheet light guide BA-IR2.53S



Applicable to:

- Analog light barrier PR0041-x-x-x-4,7
- Color Sensor PR0047/0048/0079/0094

Part number	BA-IR2.53S
Material	Glass
Aperture	0,25 mm x 38 mm
Aperture angle	60 degrees
Bending radius	50 mm min.
Length	900 mm
Operating temperature	-30 to +140 degrees °C