

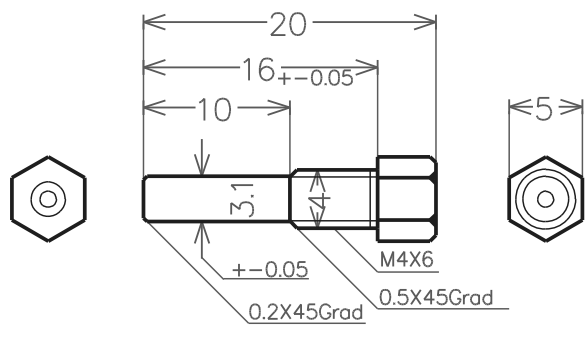

## Data sheet plastic light guide PR-LL-FG31-SMA-1000



Part number	PR-LL-FG31-SMA-1000
Core diameter	1mm
Outside diameter	2,2 +/-0,1mm
Aperture angel	60 degree
Material	Plastic 1mm POF
Length	500, 1000, 1500, 2000 mm
Bending radius	at least 35 mm
Constant tensile strength	max. 10 N
Temperature at work	-30 bis +70 degree °C